

# ACCESSORIES

## HOW TO FIT TO BED

### BED RAIL / BED STICK

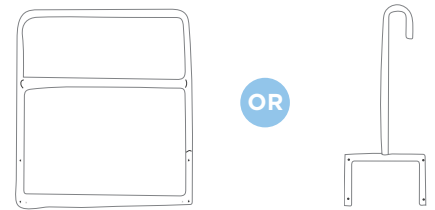

ACCESSORIES	BED RAIL BEA830210	CROOK HANDLE BED STICK BEA830200
-------------	--------------------	----------------------------------

For further installation and operating instructions, refer to the **User Manual**.

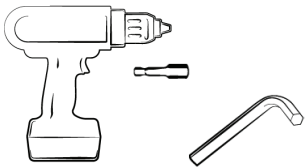

#### Tools Required:

- Allen Key (5mm)
- Impact driver or drill (5mm Hex bit attachment)

**NOTE:** It is suggested that an impact driver or drill is used to speed up this process. If the impact Driver/Drill has a clutch setting, it should be set to low torque to minimise any risk of bolt misalignment or mount point damage.

**1** Adjust bed for simplified installation.  
To adjust:

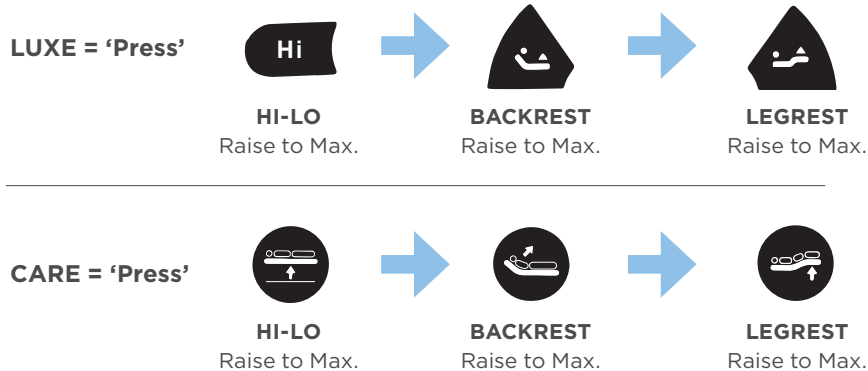

**2** When fitted, the bed rail or bed stick secures the mattress in place. To avoid collision, the head end mattress retainer should be removed on the side that the bed rail or stick is fitted to.



3 ComfiMotion beds have pre-installed mounting points for accessories.

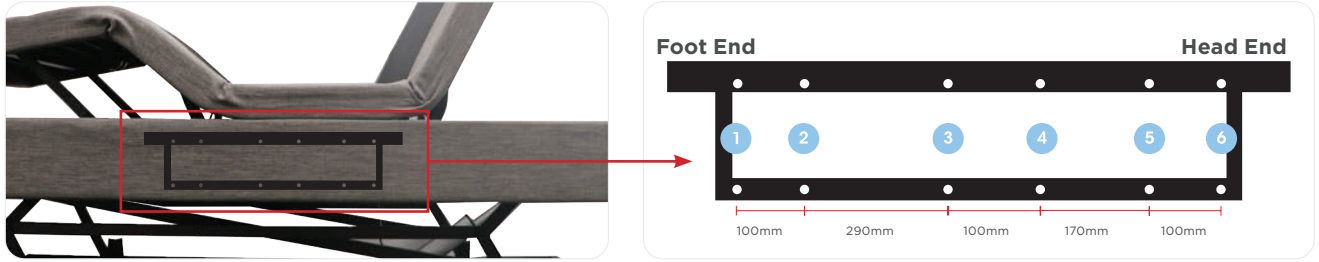

**NOTE:** Frame not visible through upholstery, for instructional purposes only.

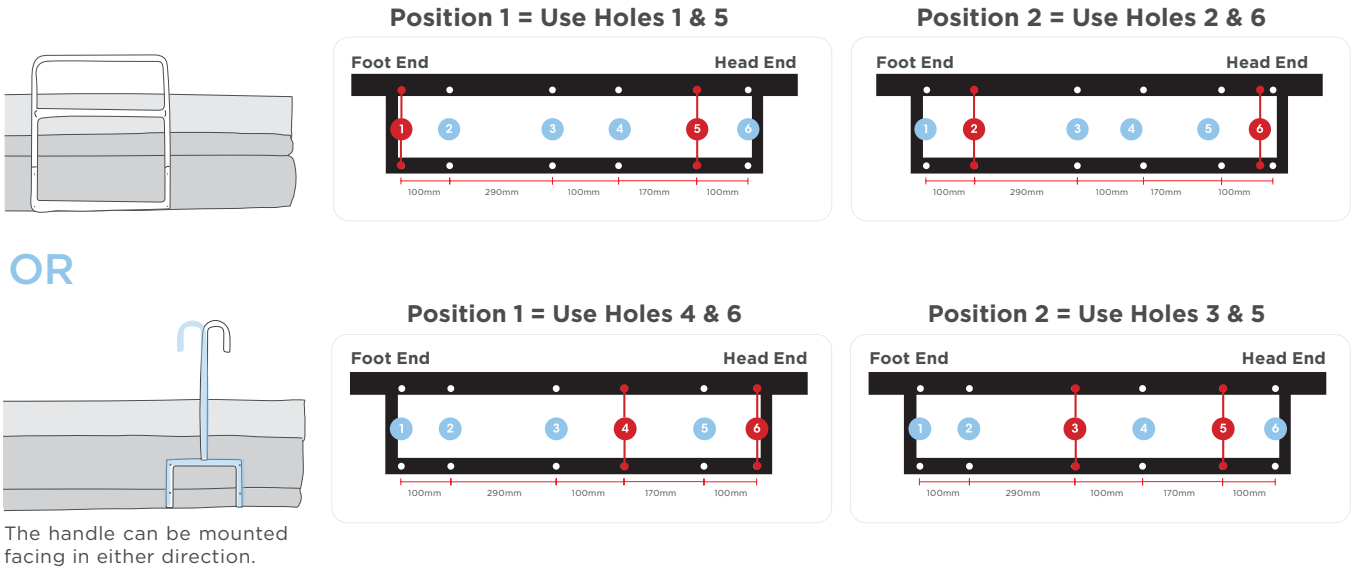

4 a. Locate mounting holes for bolt insertion.  
**To locate holes:** Press on upholstery in line with frame hole and the threaded hole insert can be felt with fingers.

b. Using an impact driver or allen key, rotate bolt through the upholstery inwards towards frame. Through rotation the bolt will pierce through the fabric and thread into pre-installed frame thread.

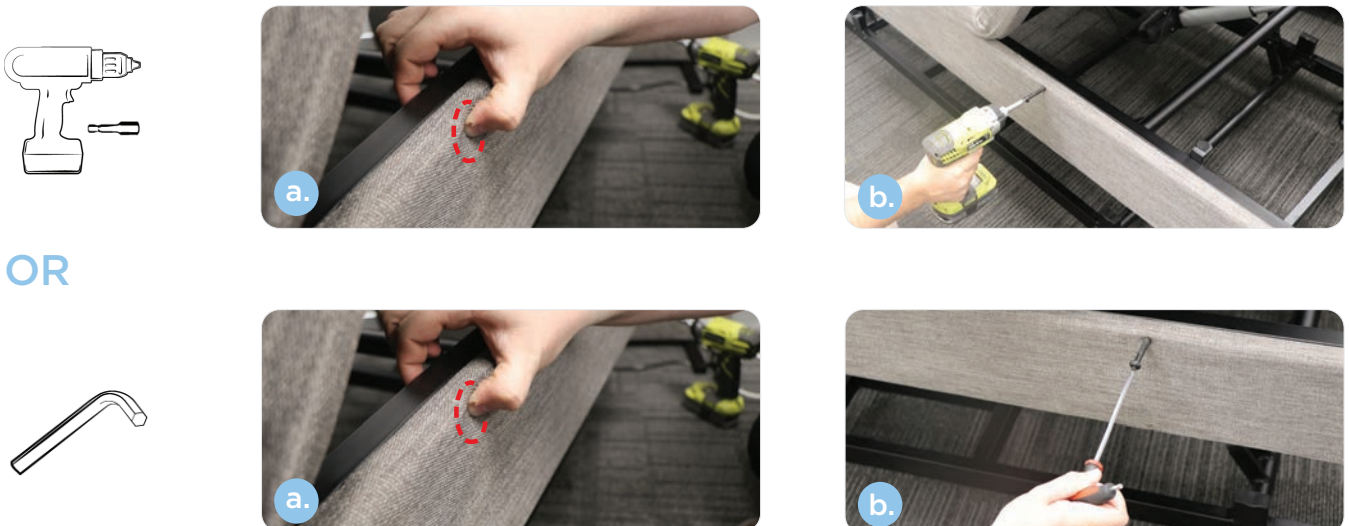

5 After creating your pre-drilled guides (x4 total), remove the bolts from the bed frame to install the rail.

6 Thread the bolt 1, rail 2, and spacer 3 into the pre-drilled hole 4 on each side.

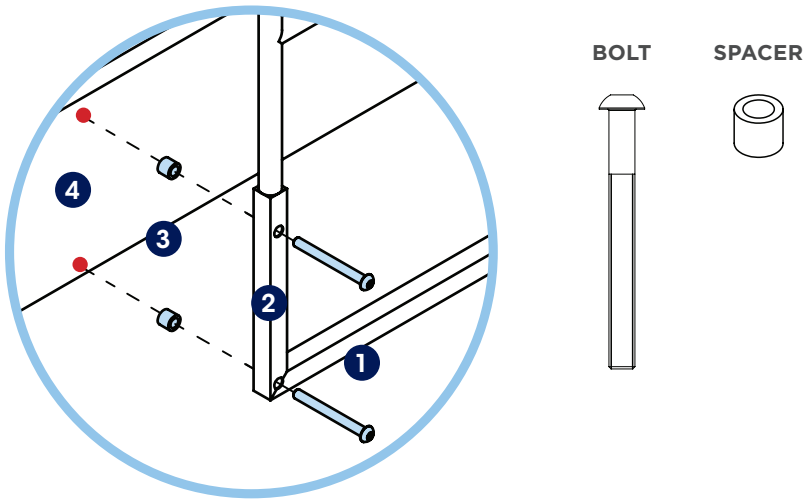

7 Tighten each bolt (x4 total) with a 5mm Allen Key or using an electric drill (with 5mm hex bit), to secure.

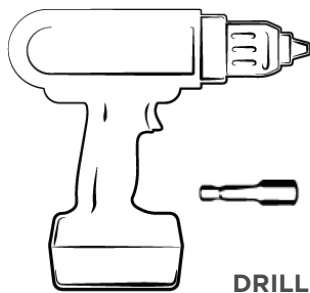

**NOTE:** As bolts pierce upholstery, holes need to be covered up. If bed rail or pole needs to be repositioned, use (M8 x 60mm) and fasten in place, this will remove the exposed hole and tidy up the side of the bed.  
**Bolt kits available:** Itexm Code: GSP640110.



**AIDACARE PTY LTD**

Building 3A, 1 Moorebank Avenue,  
Moorebank NSW Australia 2170  
1300 133 120 | [www.aspirecare.com.au](http://www.aspirecare.com.au)

**MADE IN PRC**

